

Lumber Conveyor Chains·81X Series & Attachments

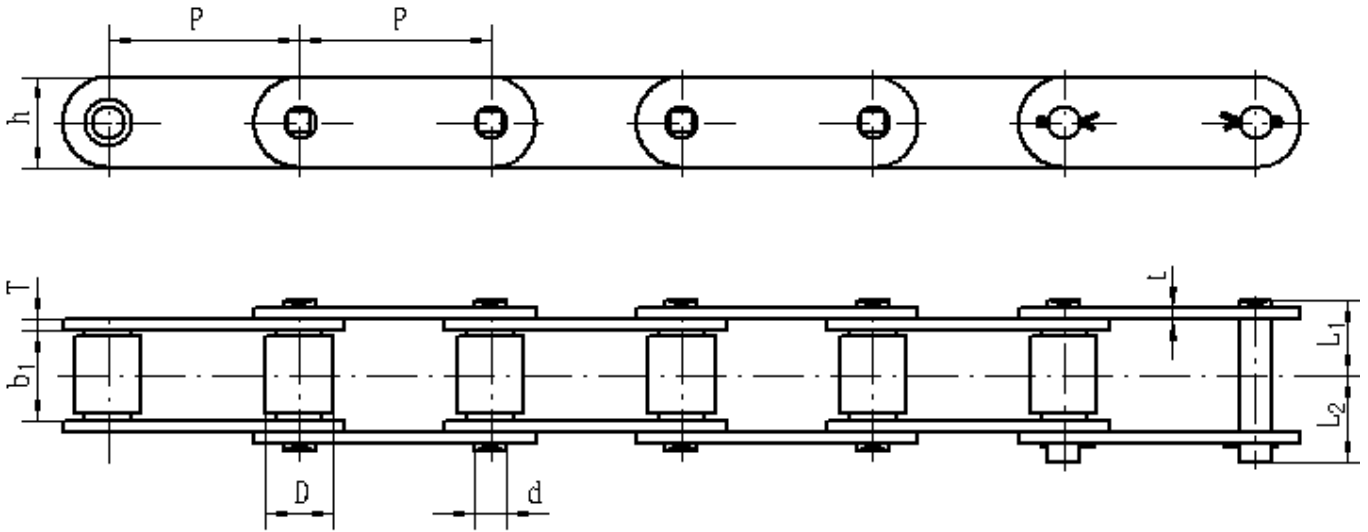

Chain No.	P mm	b ₁ (min) mm	D(max) mm						Q _{min} kN	Q ₀ kN	q kg/m
				d mm	L ₁ mm	L ₂ mm	h mm	t/T mm			
81X	66.27	26.99	23.02	11.1	24.5	27.8	28.6	4	106.7	128	3.8
81XH	66.27	26.99	23.02	11.1	29.6	32.7	31.4	5.6/7.5	152	175	5.83
81XHH	66.27	26.99	23.02	11.1	31.5	34.8	31.4	7.5	186.7	205	6.47
81XA	66.27	38	23.02	11.1	30.4	33.6	28.6	4	132	145	4.30
81-XH	66.27	26.99	23.02	11.1	30.1	33.2	32.1	5.6/8	152	175	6.11
81-XHH	66.27	27.84	23.02	11.1	32.9	36.2	32.1	8	186.7	205	6.97
81X-KC	66.27	26.99	23.02	11.1	25.13	28.43	28.6	4	98	147	3.82
81XXH	66.27	26.99	23.02	11.1	31.5	34.8	31.4	7.5	152	175	6.47
*81XH-SAS	66.27	26.99	23.02	11.1	29.6	32.7	31.4	5.6/7.5	105	115	5.54
**81XSS	66.27	26.99	23.02	11.1	24.5	27.8	28.6	4	43	47	3.76
**81XHSS	66.27	26.99	23.02	11.1	29.6	32.7	31.4	5.6/7.5	105	115	5.74

Q_{min} KN = Ultimate tensile strength

Q₀ kN = Average tensile strength

*Chains: The material of plates is stainless steel

**Chains: The material of all component parts is stainless steel

